

33ft ELA Offshore Living Quarter
- with 2 bunk beds -
 Type: PREMIUM PLUS

ela[container]



Brief Description

The 33ft ELA Offshore PREMIUM PLUS is specially designed for offshore use and is **applicable for non-hazardous areas**. The containers are applicable on offshore units such as platforms, rigs, jack-up barges and pontoons.

Every Container is basically equipped with...

- + interior corridor with two separate rooms
- + B15 walls and ceiling with A0 insulation
- + B15 internal doors and A60 outer doors
- + A60 window 600 x 800 mm in each cabin
- + a prewiring for connection to existing PA/GA-System
- + power and internet sockets, switches, lights, loudspeakers
- + HVAC-System for heating and cooling (-20° to +40 °C)
- + air circulation system in all cabins and corridor
- + fire dampers and fire extinguishers
- + internal piping and cable connections

The Living Quarter is additionally equipped with...

- Furnishings for 4 people:
- + bunk beds with bed lights. Clarification with company rules, the flag state or the appropriate worker's union necessary
 - + storage cabinets below the beds
 - + wardrobes
 - + desks with chairs
 - + optional: flat-screen TV and internet connection
 - + sanitary units (one per cabin), each with:
 - 1 WC, shower, wash basin, mirror and a 30 L / 7.9 US gallon water heater
 - + coat hooks
 - + wastewater connection: DN 100 mm / 4 in.
 - + freshwater connection: 3/4 in. with a max. pressure of 4 bar / 58 psi
 - + electrical connection value approx. 8 - 10 kW

Features

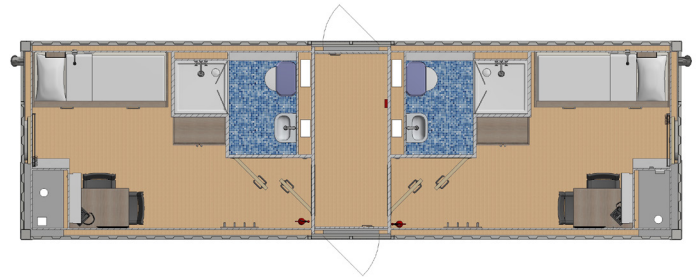

Certificates and Approvals

- + DNV 2.7-3
- + High Cube

Dimensions

- + L 10000 mm x W 3000 mm x H 2896 mm
- L 33 ft x W 9 ft 85 in x H 9 ft 6 in
- + Inside height: 2450 mm / 8 ft

Weight

- + MGW offshore: 9.5 t / 20,944 lbs.
- + Tare weight: 9 t / 19,841 lbs.

Electrical Power Requirements

- + Main outside connection: 400 V / 50 Hz
- Alternative: 440 V or 460 V / 60 Hz
- + Inside power: 230 V
- Alternative: 110 V
- Electrical installation according to VDE 0100.